

# Easy Load Pump Head

## HandyPump



### Product Features

- | Beautiful appearance, compact size
- | Flow rate range: 0.0033-365.69mL/min.
- | Front knob to open the pump head, save space.
- | Automatic tubing retention makes tube loading easy and quick.
- | Single and dual-channel head available.
- | 5 different sizes tubing to meet different flow rate requirements.

### Dimension Drawing (Unit: mm)

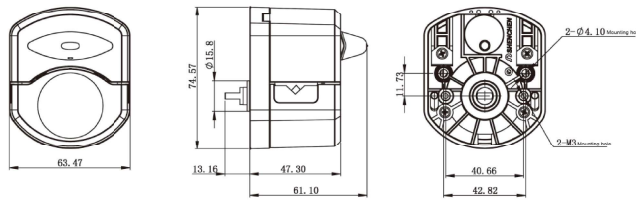

Single channel HandyPump01

Dual channel HandyPump02

### Tubing Installation Procedure



A. Turn the knob anticlockwise 180°, open the upper block.



B. Put the tube between rollers and upper block, tighten up the tubing lightly.



C. Turn the knob clockwise 180°, put the upper block back to original position, fasten the tube.

Pump Head	Channel number	Tubing	ID×Wall thickness(mm)	mL / r	Speed(rpm)	Flow Rate(mL/min)	Weight(kg)
HandyPump01	Single channel	13 <sup>#</sup>	0.8×1.6	0.033	0.1~300	0.0033~10.03	0.224
		14 <sup>#</sup>	1.6×1.6	0.187		0.0187~56.09	
		19 <sup>#</sup>	2.4×1.6	0.371		0.0371~111.17	
		16 <sup>#</sup>	3.1×1.6	0.636		0.0636~190.76	
		25 <sup>#</sup>	4.8×1.6	1.219		0.1219~365.69	
HandyPump02	Dual channel	13 <sup>#</sup>	0.8×1.6	0.033	0.1~300	0.0033~10.03	0.224
		14 <sup>#</sup>	1.6×1.6	0.187		0.0187~56.09	
		19 <sup>#</sup>	2.4×1.6	0.371		0.0371~111.17	
		16 <sup>#</sup>	3.1×1.6	0.636		0.0636~190.76	